

Puertas & Portones Automaticos, S.A. de C.V.

¡Nuestra pasión es la Solución!....

» **CIERRAPUERTAS HIDRAULICO (XL) DE SOBREPONER AJUSTABLE Y REGULABLE FUERZA 1 - 6 (15 A 150KG) MARCA ADS MOD.UL4400BC.**

- America Style Designed, Heavy Duty for Commercial Doors.
- UL Certificated, 2 Million Cycles In Endurance
- Precise Cast Iron Body & Blanking Steel Arm, Hold Open Arm Optional.
- Adjustable Closing & Latching Speed.
- Adjustable Back-Check, Delay Action Optional.
- Precision Heavy Duty Rack (Piston) & Pinion Gear , Needle Bearing.
- Decorative Plastic Cover & Stainless Steel Cover Optional.
- Barrier Free, Lower opening resistance for the handicapped / Elderly.



UL4400BC SERIES
DOOR CLOSER

(OU-00008-00)

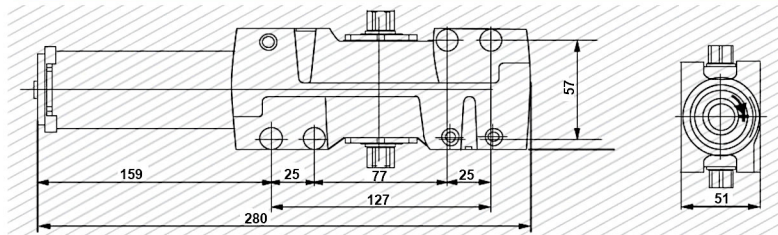

| Type | Width of door (mm) | Weight of door | | Power Size |
|----------|--------------------|----------------|--------|----------------|
| | | (kg) | (lbs) | |
| UL4400BC | 750-1400 | 15-150 | 33-330 | Multi Size 1-6 |

CROSS REFERENCES

| NORTON | CORBIN | DORMA | HAGER | LCN | RUSSWIN | SARGENT | YALE | DOR-O-MATIC |
|--------|---------|-------|-------|------|---------|---------|------|-------------|
| 9500 | DC 3000 | 8900 | 5100 | 4041 | 6200 | 281/351 | 4400 | SC 70 |

The data on this represents our judgment of which are more similar, since no product is exactly alike each ohyer, it is not guaranteed nor represented that any specific product exactly equals any other product.

| CÓDIGO | SKU | MODELO | DESCRIPCIÓN |
|-------------|--------|----------|--|
| OU-00008-00 | OB03BC | UL4400BC | CIERRAPUERTAS HID XL-A 15-150K 1400MM BC |



(229) 461-7028

portonesautomaticos@adsver.com.mx
ads.portonesautomaticos@outlook.com



V07.25